

WINPAY Deposit (E-wallet)

• • • • •

1

Click “Deposit”.

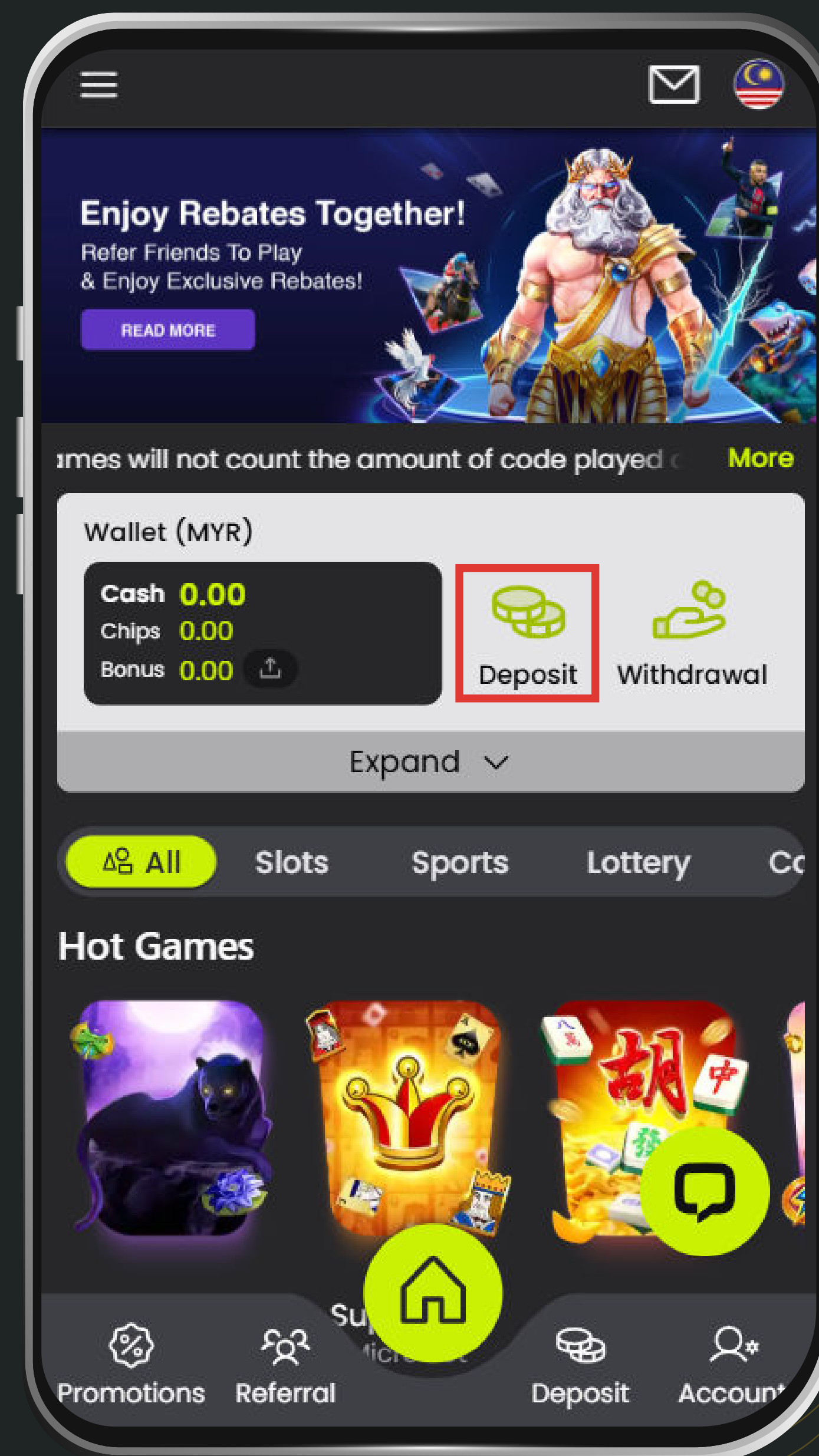

2

Select the deposit method:
WinPay E-wallet.

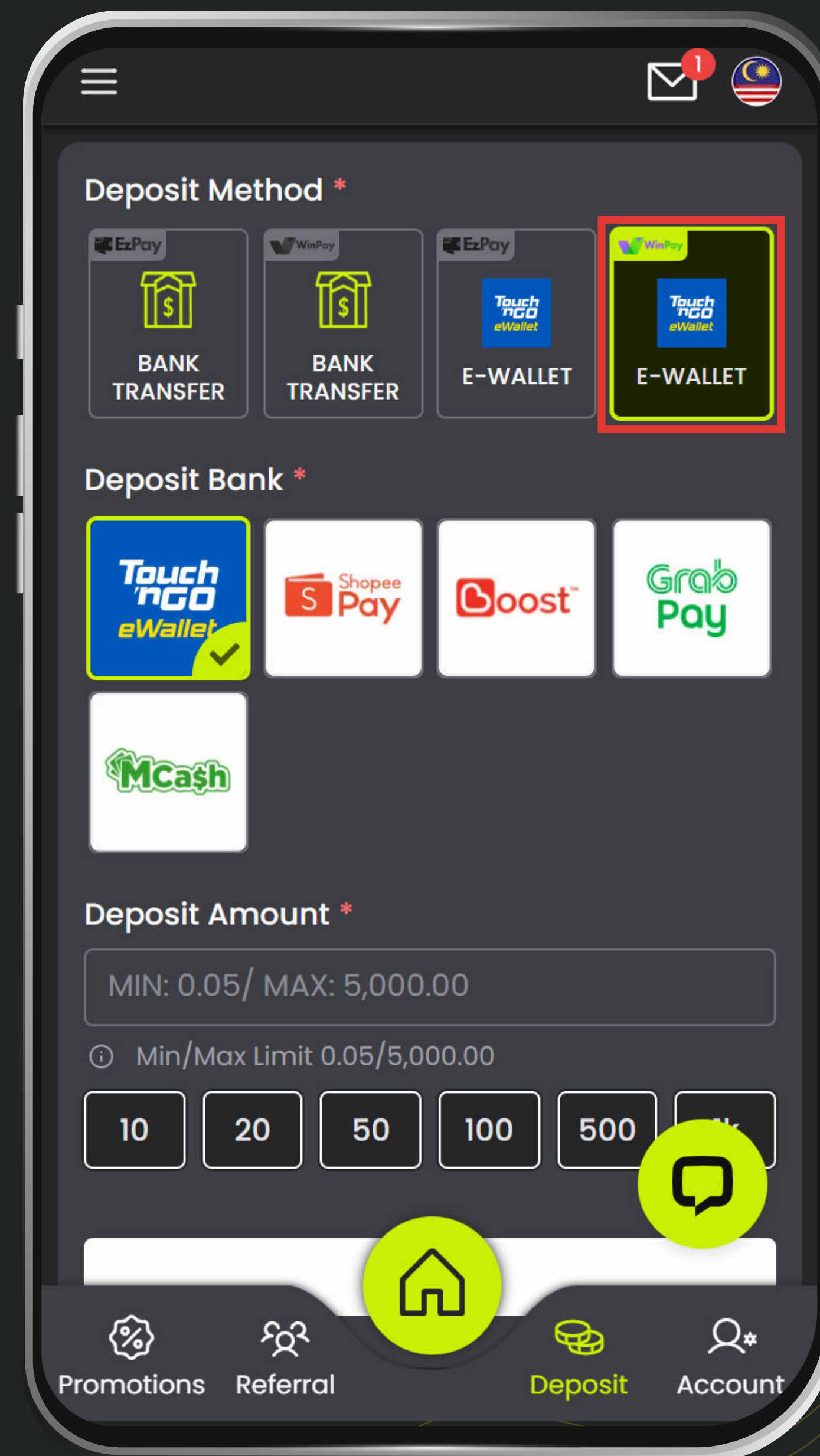

3

Choose “Touch n Go”.

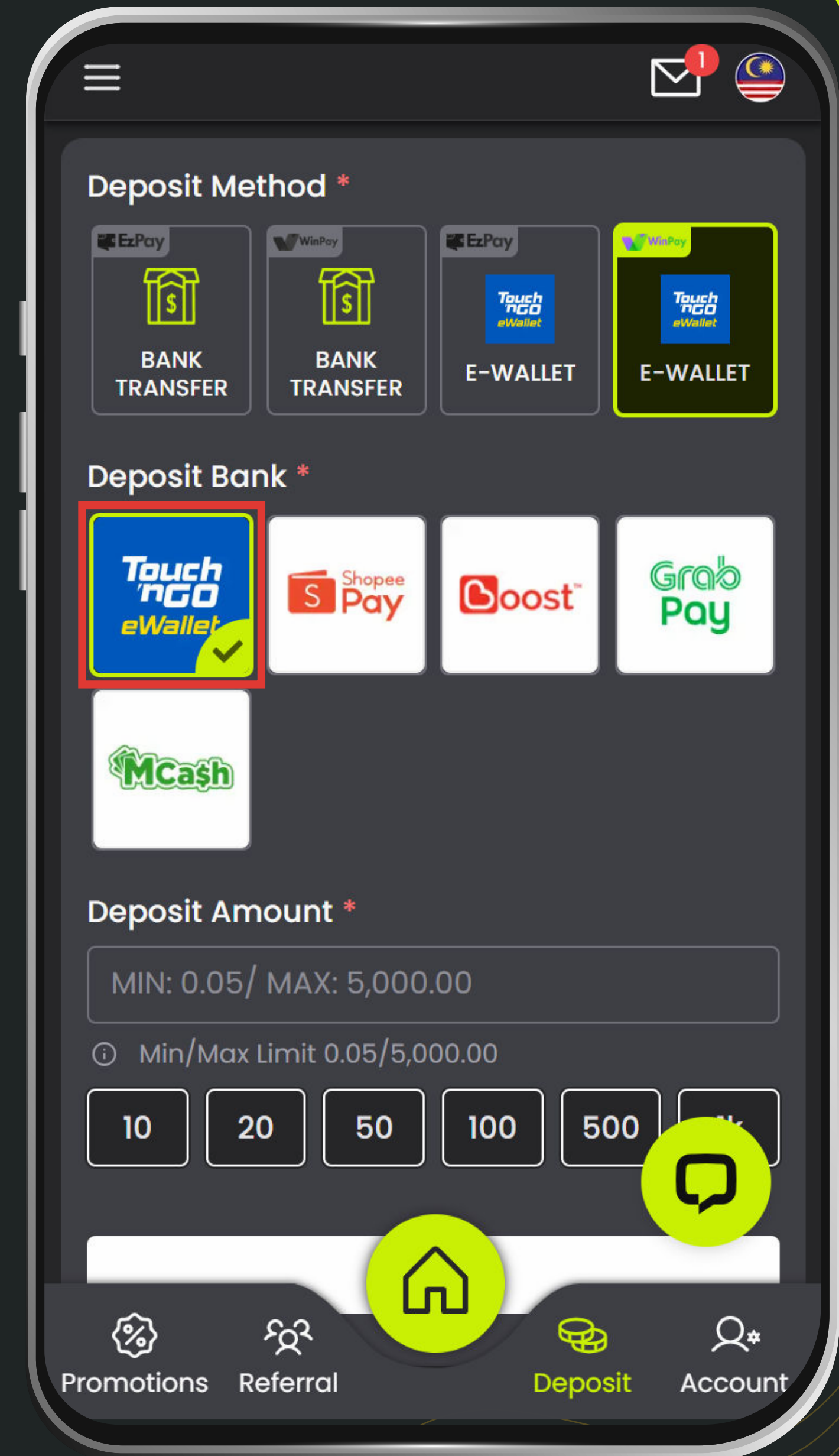

4

Please enter your
deposit amount.

Touch 'n GO eWallet

Shopee Pay

Boost

Grab Pay

Mcaash

Deposit Amount *

20.00

Min/Max Limit 0.05/5,000.00

10 20 50 100 500 1k

Submit

⚠ Important Notice

Always check for the latest active deposit bank details before making a deposit.

Cash deposits are not supported.

Promotions Referral **Deposit** Account

5

After confirming the entered amount is correct, click “Submit”.

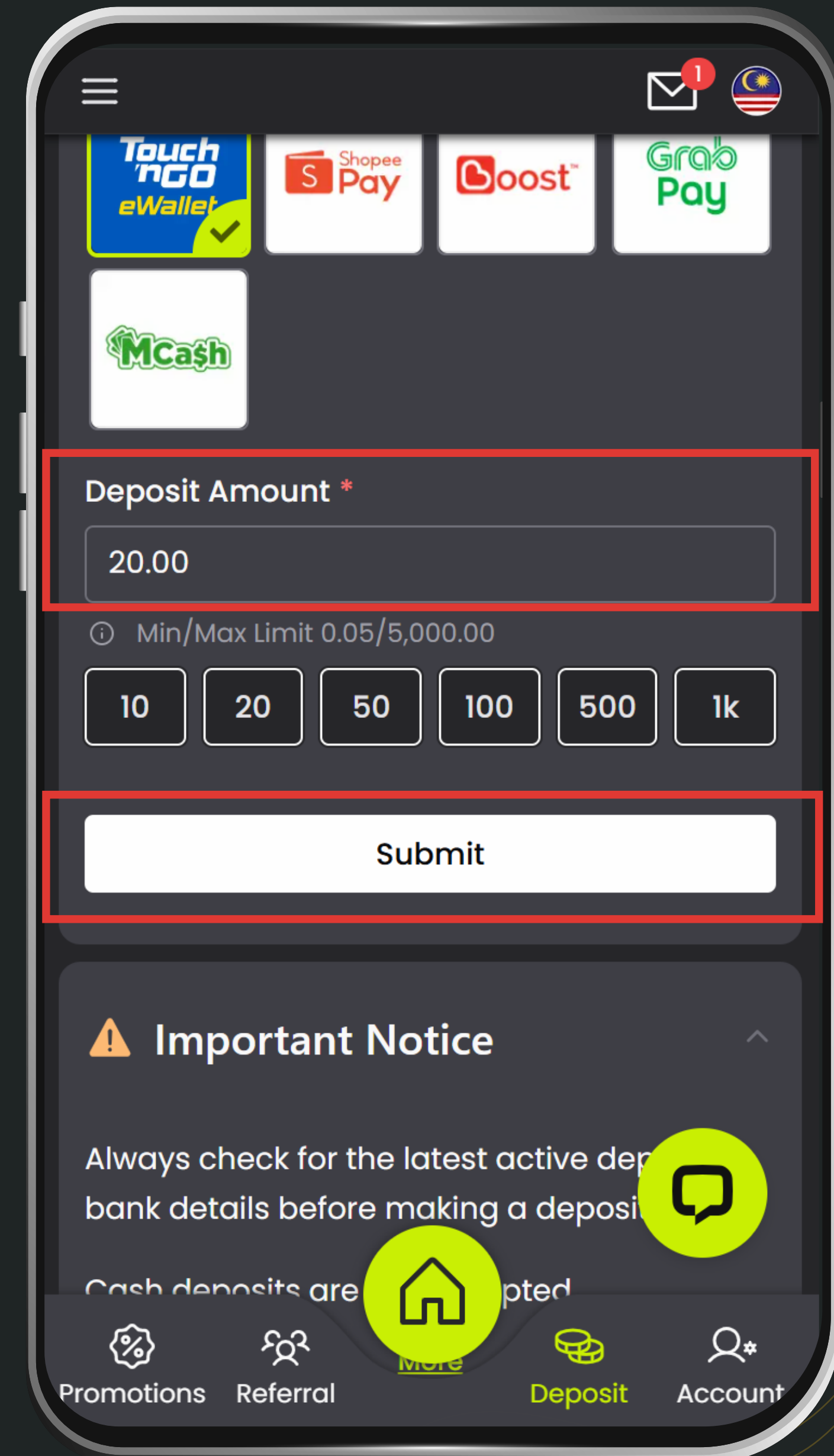

6

Please enter the Touch n Go
phone number.

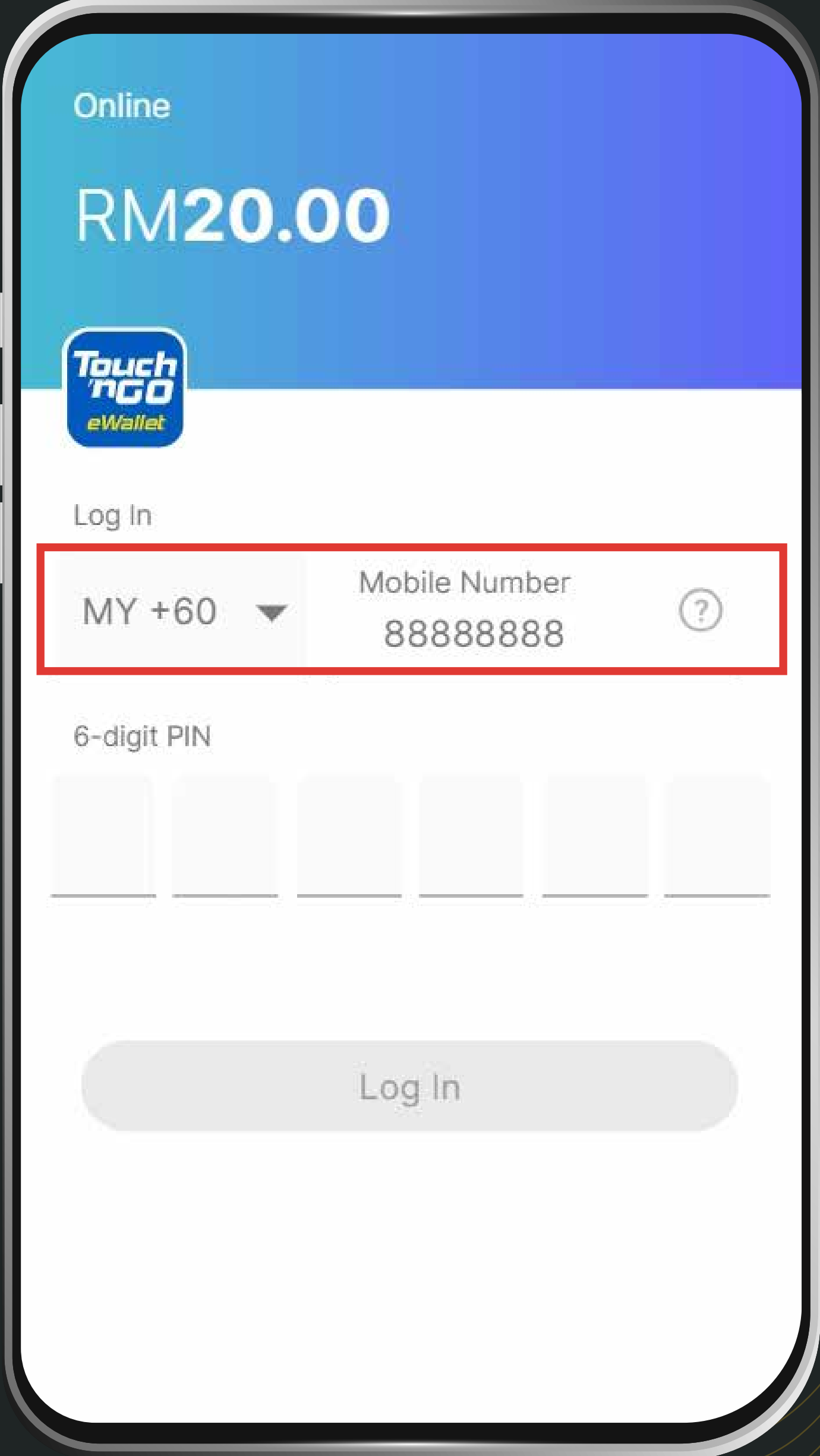

The image shows a smartphone screen displaying the Touch n Go eWallet app's login interface. At the top, it says 'Online' and shows a balance of 'RM20.00'. Below this is the 'Touch n Go eWallet' logo. The 'Log In' section is highlighted with a red border and contains a dropdown menu set to 'MY +60' and a 'Mobile Number' field with the number '88888888'. A help icon (?) is next to the number field. Below the number field is a '6-digit PIN' section with six empty input boxes. At the bottom is a 'Log In' button.

Online

RM20.00

Touch n Go eWallet

Log In

MY +60 ▼ Mobile Number 88888888 ?

6-digit PIN

Log In

7

Please enter the
security password.

Online

RM20.00

**Touch
nGO**
eWallet

Log In

MY +60 ▼ Mobile Number 88888888 ?

6-digit PIN

• • • • • •

Log In

8

Redirecting in
progress...

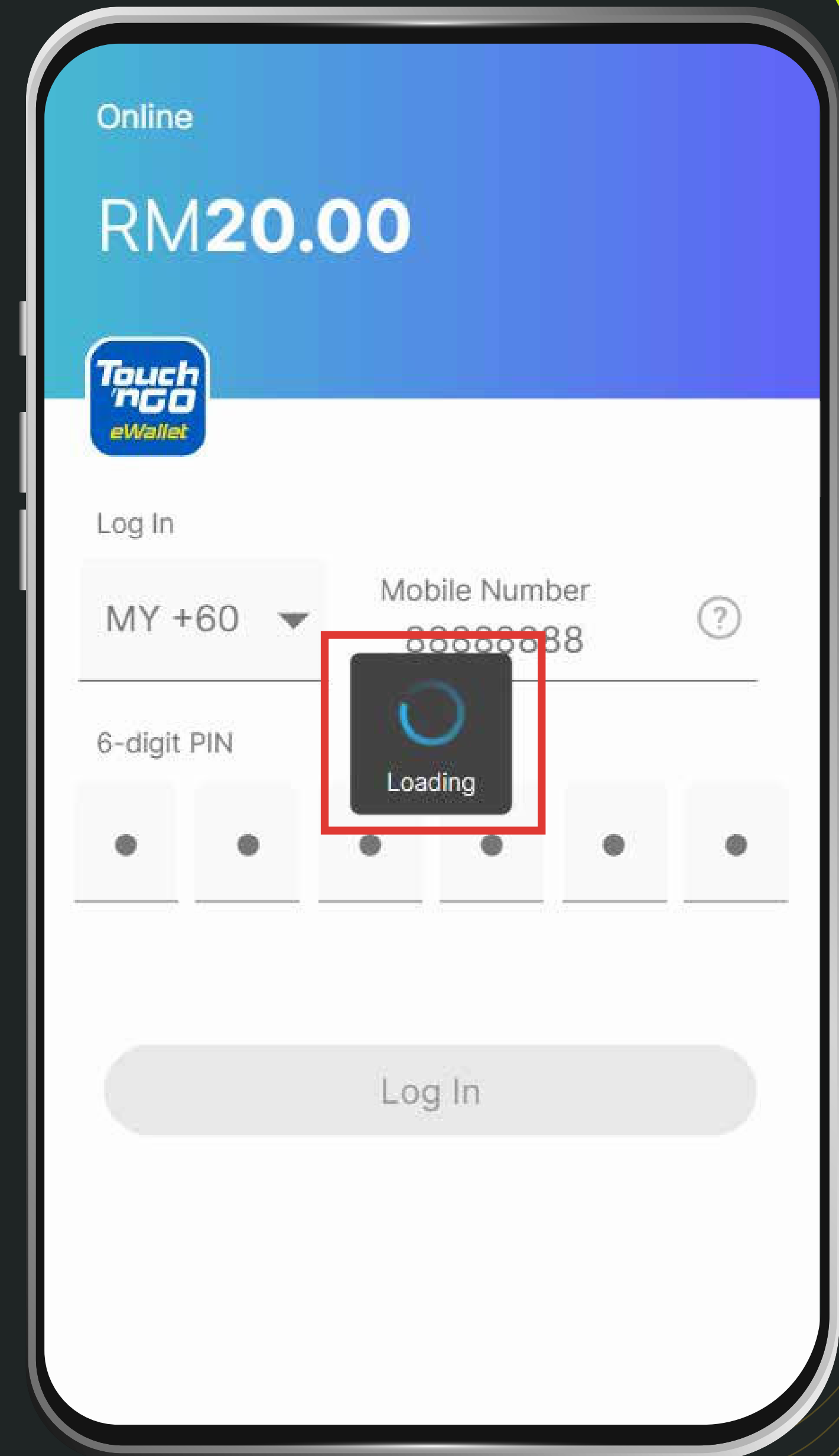

9

Click “Pay”.

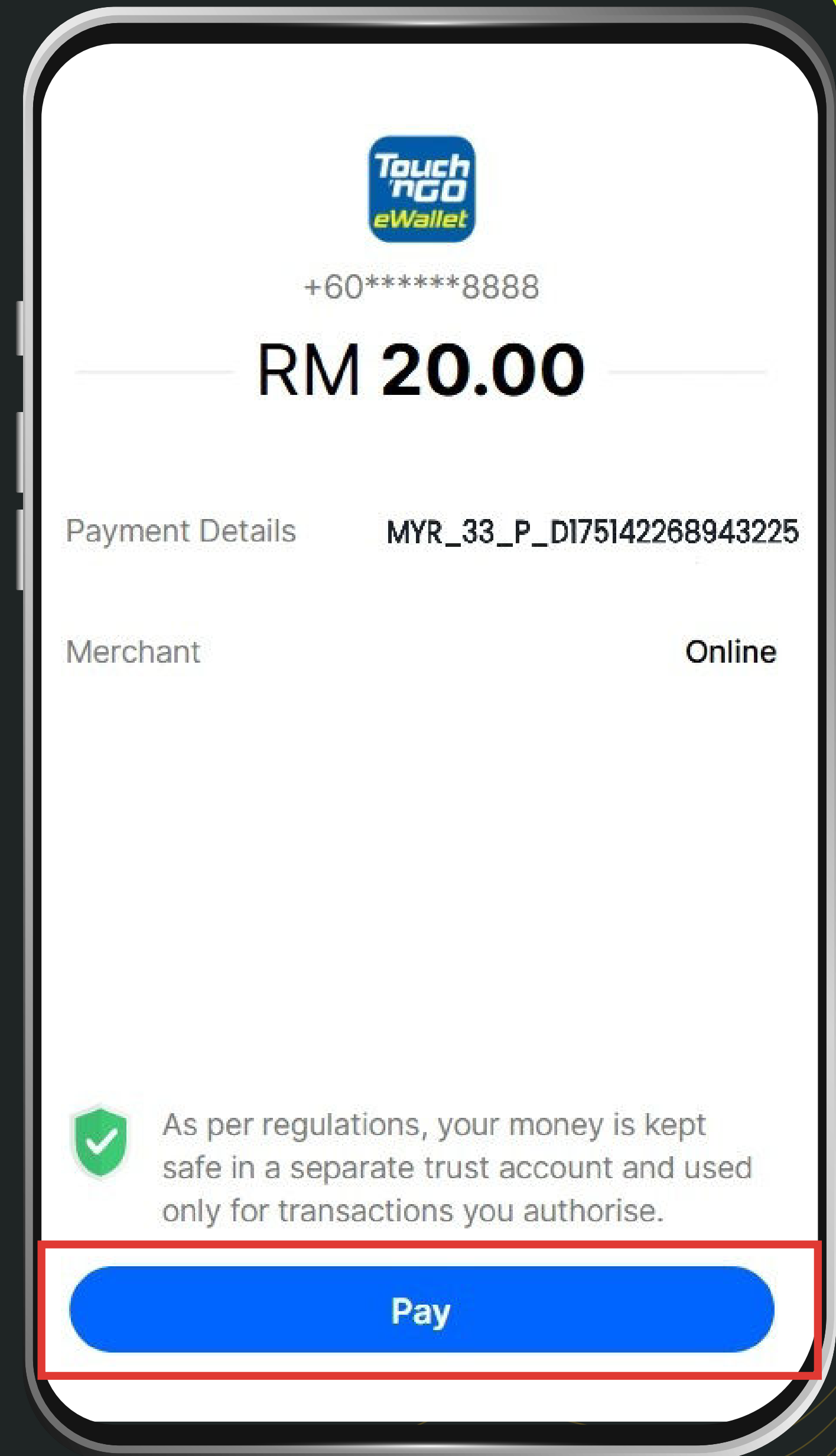

10

**Deposit completed
successfully.**

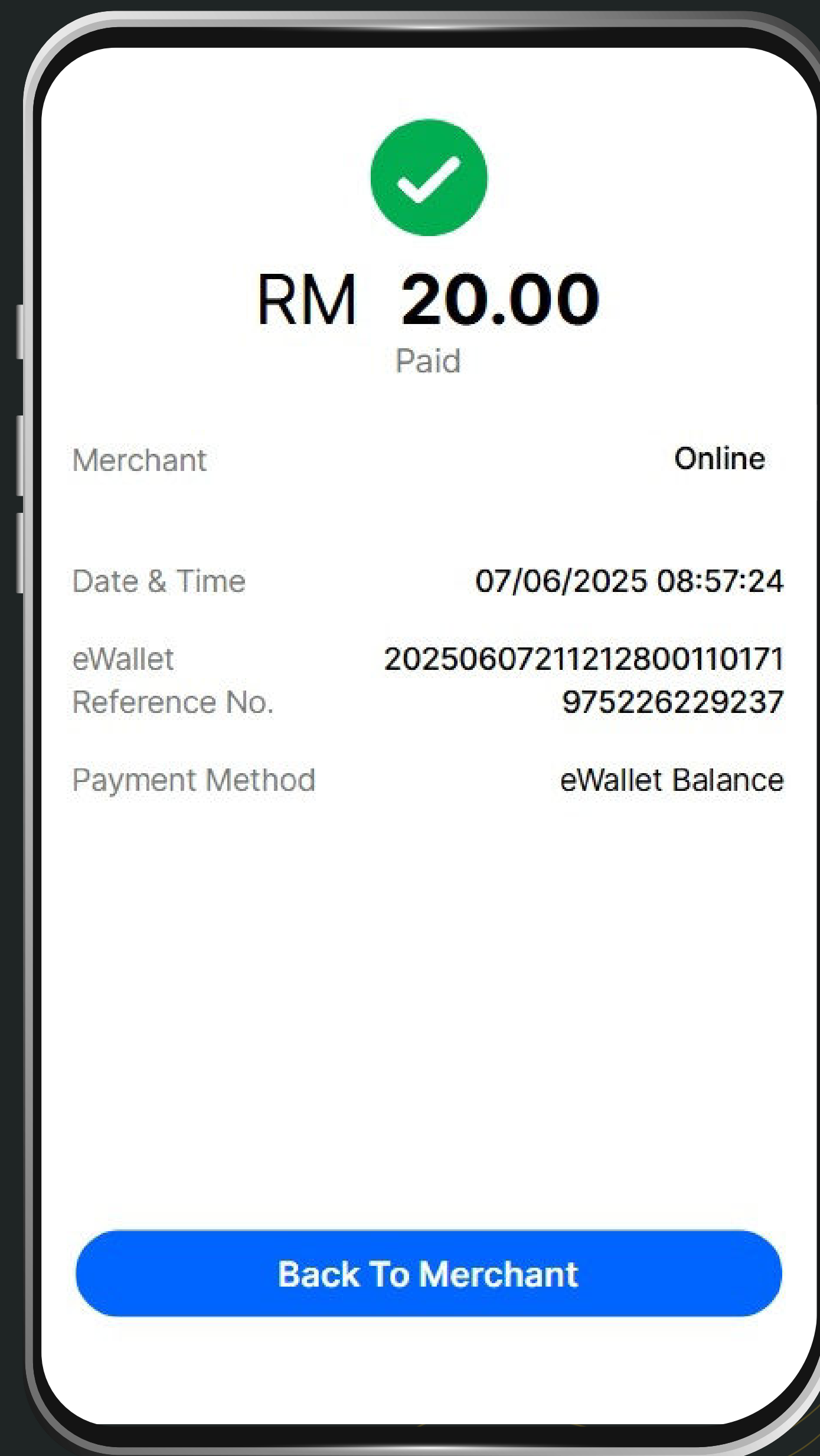

At this point, the system will redirect one more time for you to confirm your deposit information.

